

# O2™ Series Corporate Office Furniture | Grade 2 | Thin Base

## \*\*HOUSING 1\*\*

### [7] POWERED STATIONS:

- [5] 5'W x 2'D x 53"H STRAIGHT POWERED STATION W/
- [1] BOX BOX FILE PEDESTAL /EA
- [1] 60"W OVERHEAD W/ FLIPPER DOOR /EA

## \*\*HOUSING 2\*\*

### [13] POWERED STATIONS:

- [10] 4'W x 2'D x 39"/53"H STRAIGHT POWERED STATION
- [3] 4'-6"W x 2'D x 53"H STRAIGHT POWERED STATION W/
- [1] BOX BOX FILE PEDESTAL /EA
- [1] 48"W OVERHEAD W/ FLIPPER DOOR /EA (FROM STATION #4 TO #13)
- [1] 30"W + 24"W OVERHEADS W/ FLIPPER DOOR /EA (FROM STATION #1 TO #3)

## \*\*SOAR OFFICE\*\*

### [1] NON-POWERED ROOM:

- [1] 10'-9" x 7'-6" x 85"H NON-POWERED ROOM W/ GLASS SLIDING DOOR (NO FURNITURE)

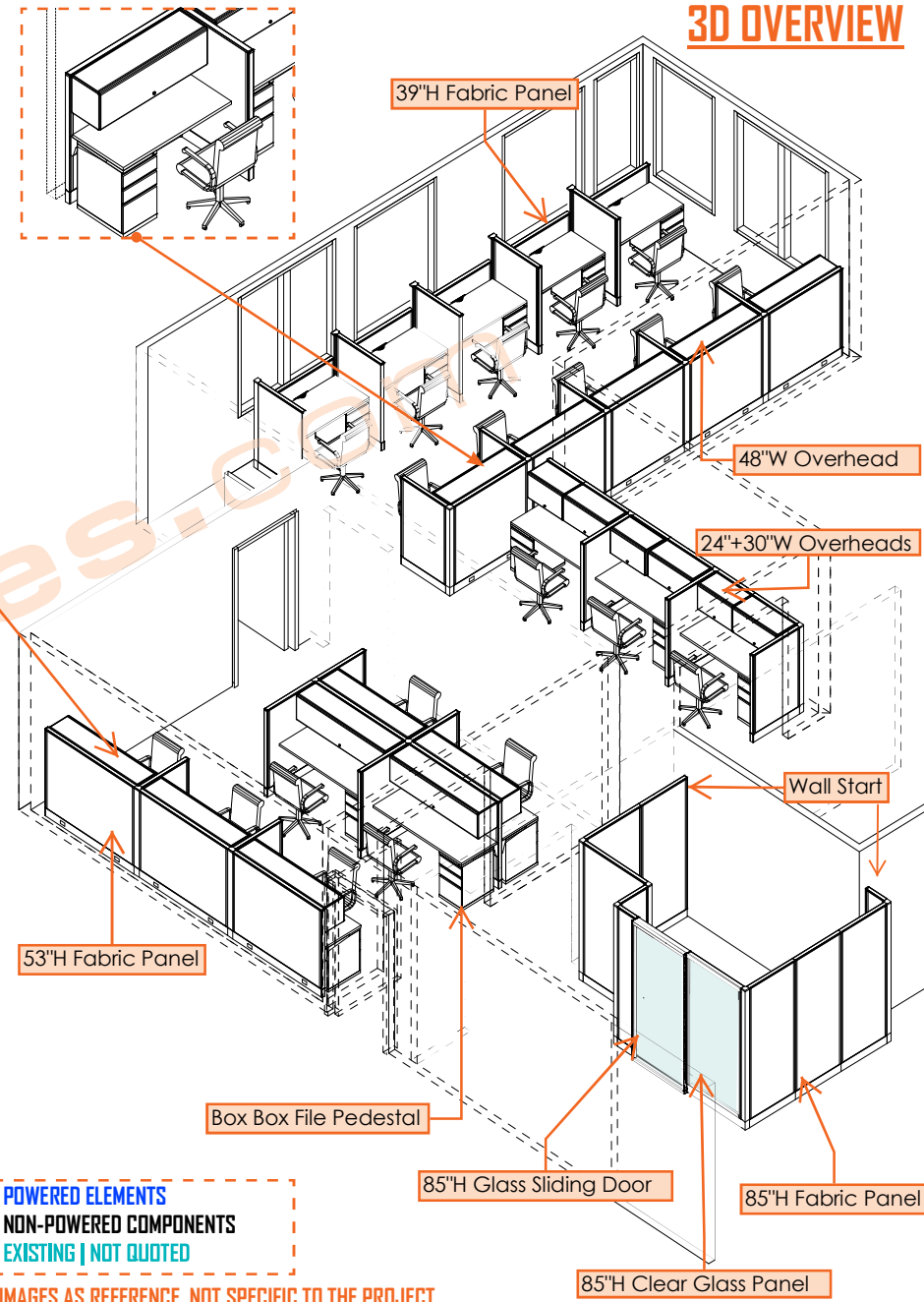
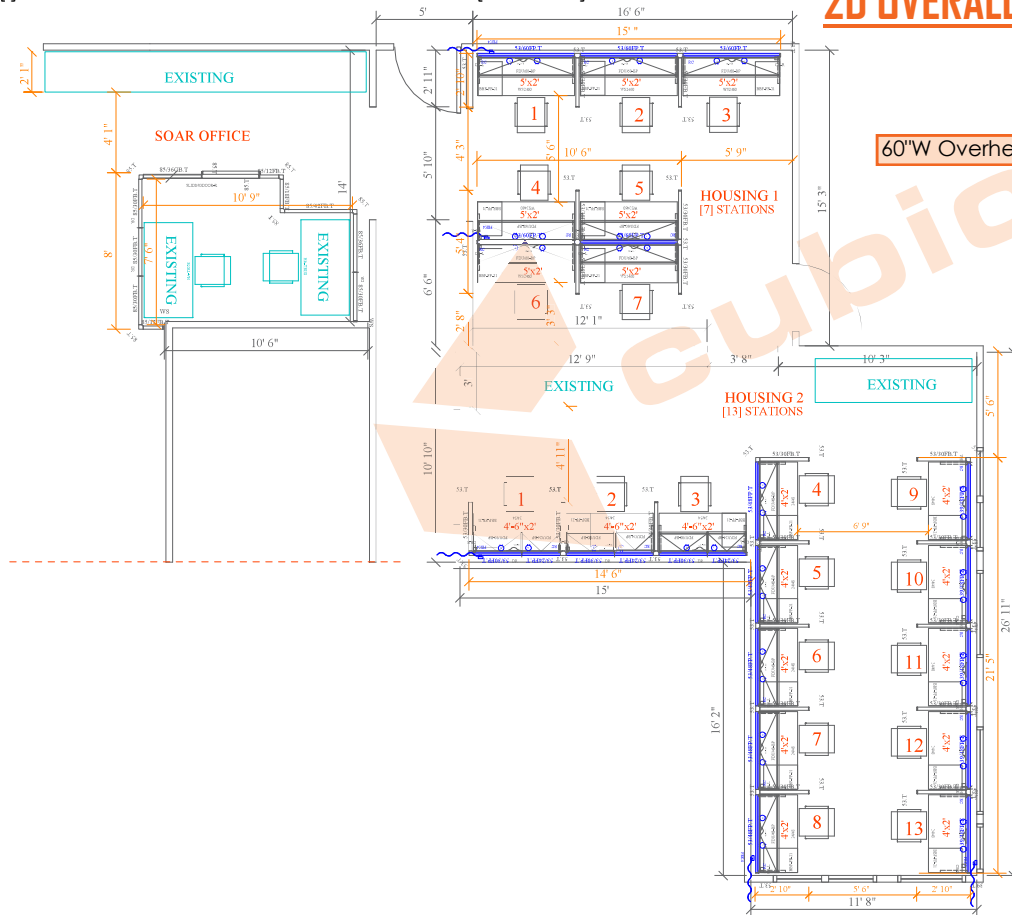

- POWERED ELEMENTS
- NON-POWERED COMPONENTS
- EXISTING | NOT QUOTED

- IMAGES AS REFERENCE. NOT SPECIFIC TO THE PROJECT.  
 - SEATING NOT INCLUDED (AVAILABLE UPON REQUEST)